

mjm [®] **4**



The Evolution of a Day Yacht

MJM Yachts are world-renowned for their timeless style, high-tech construction, and superior materials. The 4 is an impressive day yacht featuring 4 social zones and a galley-up layout. Below deck features a large v-berth as well as a double berth amidships. With the protection of a pilothouse, innovative spacious layout, and exceptional stability, she is all about style, comfort and fun. Built in the U.S.A.

MJM 4 DISTINCTIONS

- FOUR SOCIAL AREAS FOR RELAXING AND ENTERTAINING
- BEST IN CLASS STABILITY AND SMOOTHNESS OF RIDE
- LOW NOISE, LOW MAINTENANCE OUTBOARD POWER
- LIGHT, STRONG, HIGH-TECH COMPOSITE CONSTRUCTION
- INDOOR-OUTDOOR PILOTHOUSE
- GALLEY-UP LAYOUT
- LARGE "L" SHAPED COCKPIT SEATING
- JOYSTICK DOCKING
- OPENING ELECTRIC WINDSHIELDS
- SLIDING SIDE WINDOWS
- SIDE BOARDING DOOR
- QUICK GYROSTABILIZER OPTION





TRIPLE 300 HP VERADOS



TWIN 600 HP VERADOS



Available 2024
TWIN 440 HP VOLVO DPI

mjm. 4

Enjoy the
adventure of
day yachting
or extended
liveaboard
cruising.



KEY FEATURES

A crossover day yacht with MJM's stunning good looks and inspiring Carolina Downeast style. She is a unique blend of an open bow day yacht and performance cruiser with impressive overnight accommodations.

- Best in class performance
- Yacht sized head with enclosed glass shower
- Cruising helm with companion seat
- ISO Certified Category "B" Offshore
- Variable power options

SPECIFICATIONS

LENGTH OVERALL	46' 8"
LENGTH ON DECK	42' 7"
BEAM	12'
DRAFT ENGINES UP	25.5"
DRAFT ENGINES DOWN	36"
DISPLACEMENT	17,730 LBS
DEADRISE AT TRANSOM	18.5°
FUEL CAPACITY	475 GAL
WATER CAPACITY	110 GAL
AIR HEIGHT	9' 8"
STANDARD POWER	3X 300 HP
OPTIONAL POWER	2X 600 HP
OPTIONAL INBOARD POWER	2X 440 HP
TOP SPEED	50 MPH

Specifications subject to change

FLUSH DECK LAYOUT AND STARBOARD SIDE BOARDING DOOR



4 SOCIAL AREAS FOR COMFORTABLE RELAXING AND ENTERTAINING

Enjoy the spacious and secure comfort of the bow area while chatting with friends. The all-weather, all-conditions, indoor-outdoor pilothouse has all the amenities for day yachting. The galley-up design puts it right in the middle of all the action.



Opening electric windshields



Convertible double sunlounge aft

4 ZONE LAYOUT

Enjoy Your Time Onboard

Epics views and secure comfort for better conversations

V-berth for weekend overnighting

Yacht sized head with glass enclosed shower

Destroyer wheel

Amidships double berth

Business class helm sofa

360 degree visibility in indoor-outdoor pilothouse

Galley-up entertaining

Serving stations for an electric grill, sink, ice maker, or fridge

Side boarding door for dogs, kids and parents

Aft cockpit daybed/sofa

Transom walkthrough for landing swimming family and fish

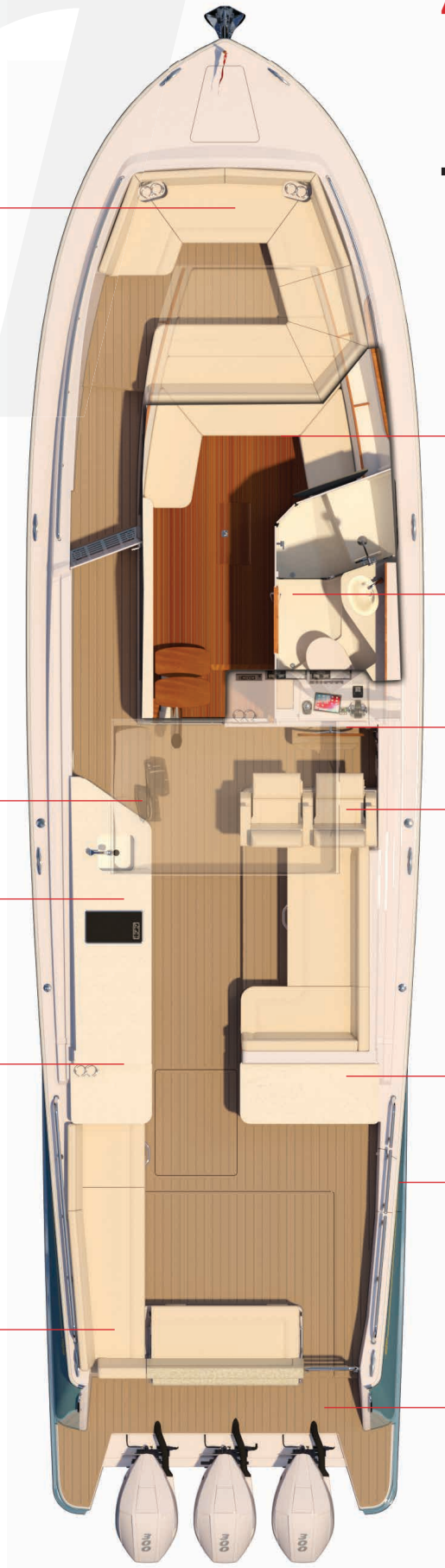



MORE ADVENTURE. MORE LUXURY.

Open air never felt so good, or so safe. The day starts with perfect weather for the run to a new beach, sand bar, or island. Epic family times ensue. The horizon darkens and the other boats pack up and leave early. We've all been there, but your 4 enables another hour or two of paradise to yourselves. The open air layout transforms to a weatherproof, dry, air-conditioned pilothouse. Everyone is happy.



Patented ride parts the seas, deflecting wave action down and aft to ride atop the waves smoothly